

EL DORADO DISPOSAL

Updates on New MRF Project



Trash • Recycle • Yard Waste

El Dorado Disposal
Safety in all we do • Service 2nd to none.

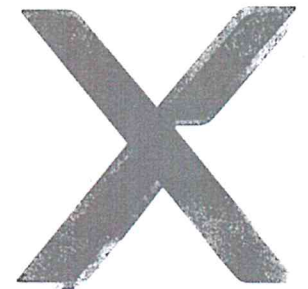

ARCH | NEXUS

BACKGROUND

Franchise agreement adopted in 2014

Waste Connections commitment to rebuild the
Material Recovery Facility (MRF)

Alignment with the Solid Waste Management Plan

LARGE WEEKEND TRAFFIC



OVERALL SMALL FOOTPRINT



TIGHT SELF-HAUL DROP-OFF & TURN-AROUND AREA

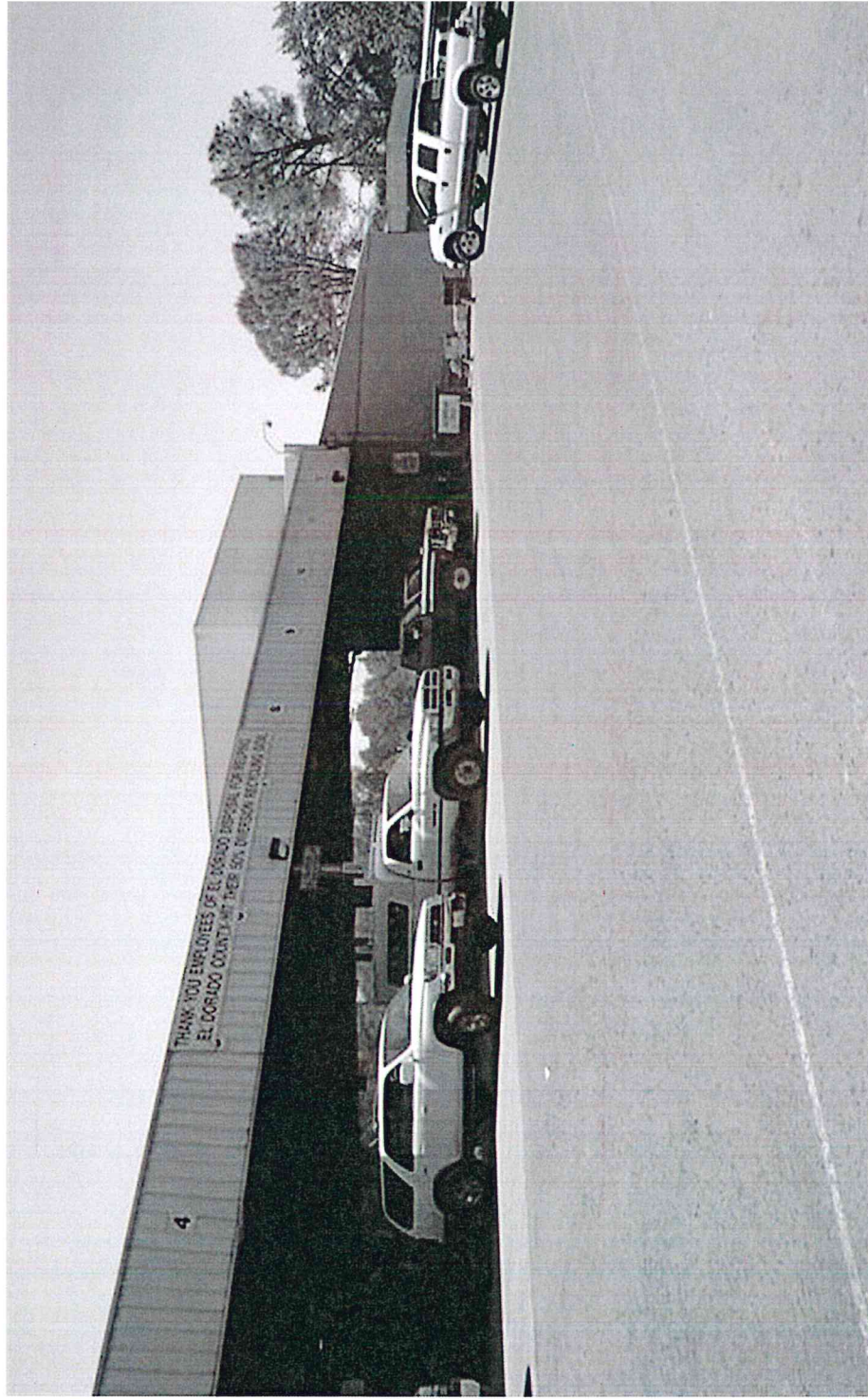

LIMITED MATERIAL STORAGE AREA

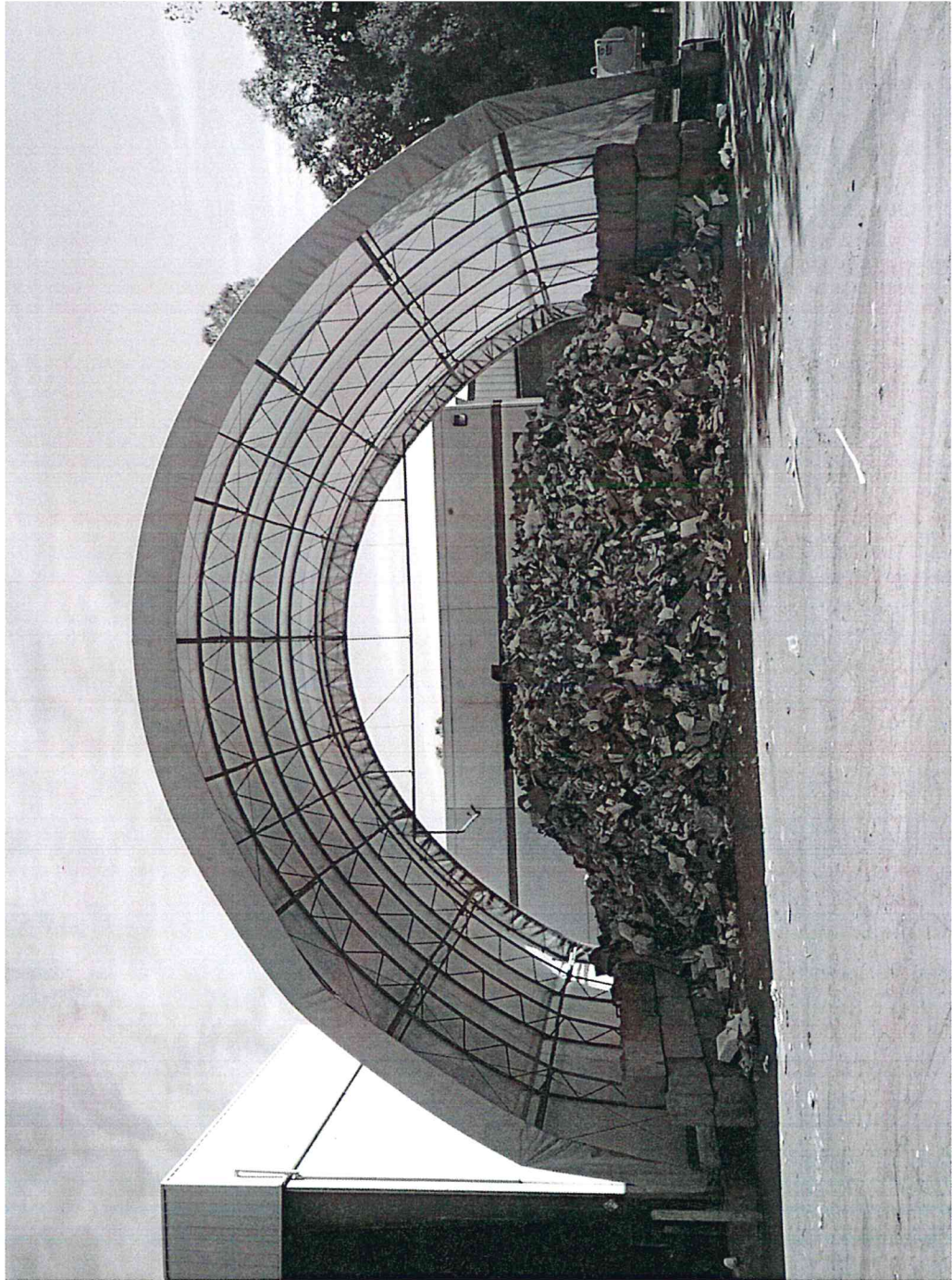

TRANSFER STATION / MRF FACILITY PROJECT

The following elements are included in the proposed building:

- Separate tipping areas for commercial and public traffic
- Separate inbound scale for commercial vehicles to separate public and commercial traffic
- A drive-through transfer load-out tunnel to improve traffic flow and loading efficiency
- Both public and commercial vehicles will unload directly onto the floor, eliminating vertical drop-offs
- The proposed door arrangement in the building will allow for the public to use two sides of the building on weekends, which typically have a large number of public transactions but little or no commercial traffic
- New HHW facility with expanded hours
- Installation of new C&D sort line and equipment
- New public education center
- New facility will meet all new state storm water regulations, providing for coverage of all material

The new building will improve efficiency and ensure all waste handling operations occur under cover

COMMERCIAL VEHICLE CIRCULATION

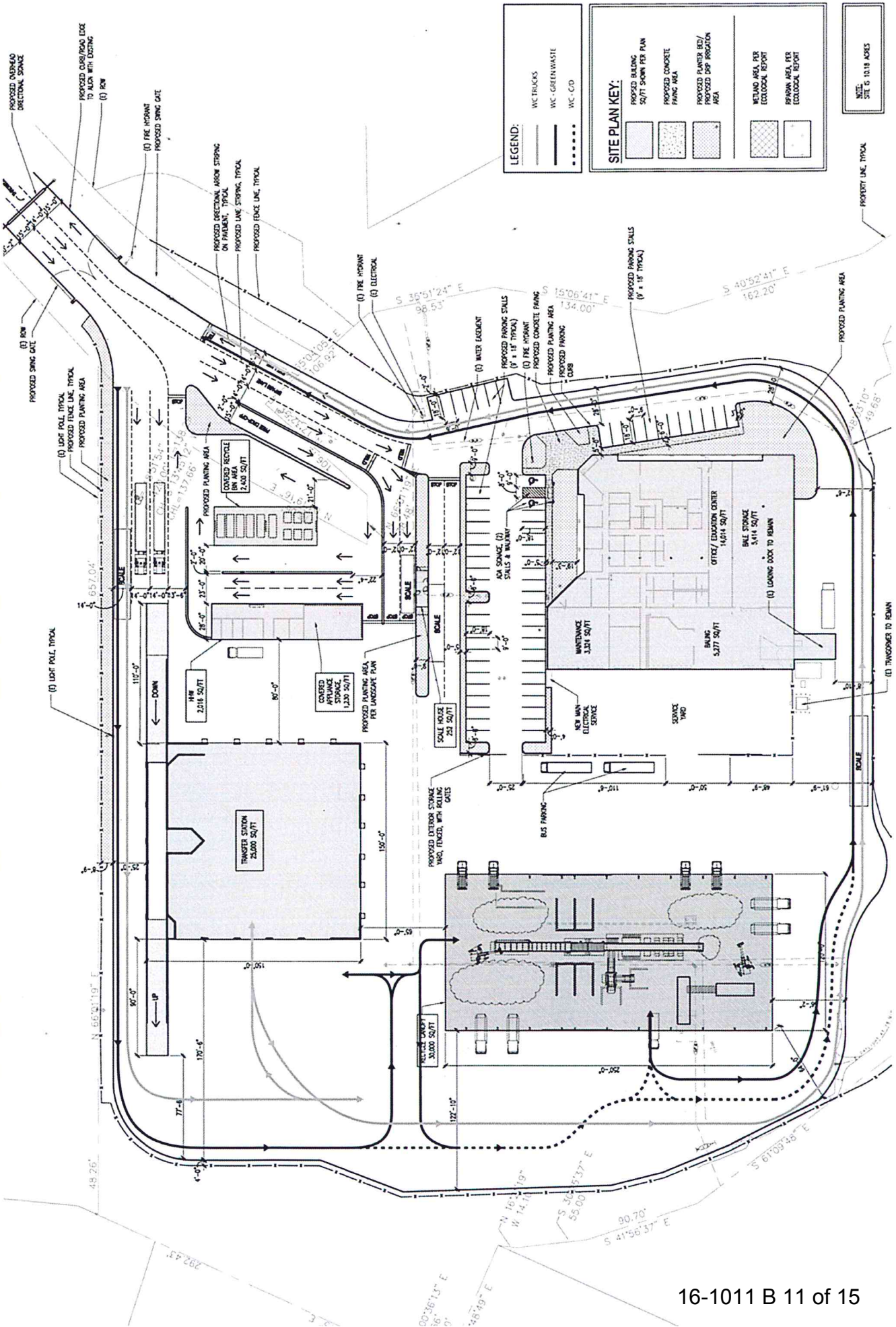

LEGEND:

- WC TRUCKS
- WC - GREENWASTE
- WC - CD

SITE PLAN KEY:

- PROPOSED BUILDING (SQ/FT SHOWN PER PLAN)
- PROPOSED CONCRETE PAVING AREA
- PROPOSED ASPHALT/PROPOSED ASP PAVEMENT AREA
- WETLAND AREA, PER ECOLOGICAL REPORT
- PERMANENT AREA, PER ECOLOGICAL REPORT

NOTE: SITE IS 10.18 ACRES

PROPOSED LANDSCAPE PLAN

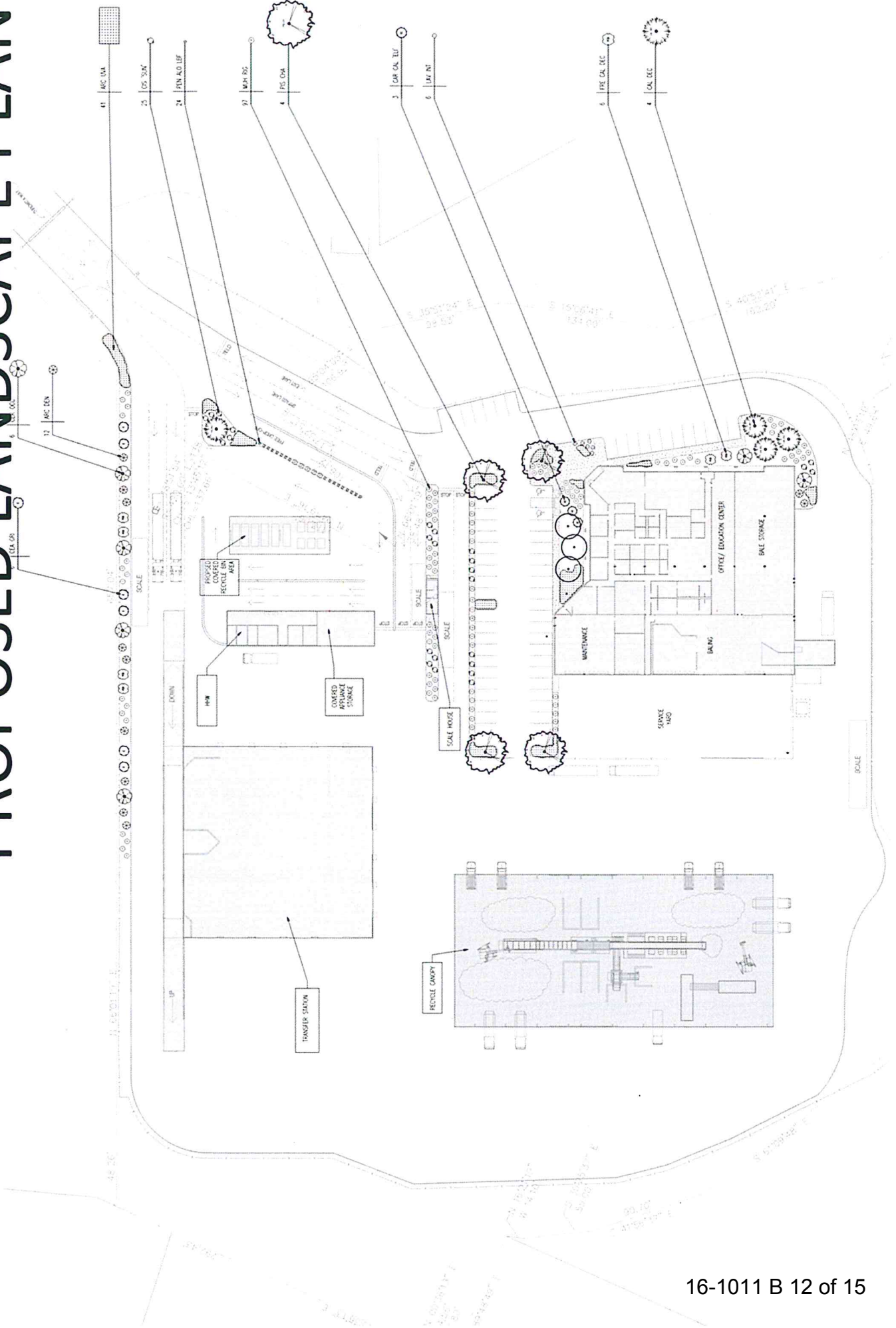

WASTE TRANSFER BUILDING



16-1011 B 13 of 15

AERIAL VIEW (existing)



16-1011 B 14 of 15

AERIAL VIEW (proposed)

