



# County of El Dorado

330 Fair Lane, Building A  
Placerville, California  
530 621-5390  
FAX 622-3645  
www.edcgov.us/bos/

## Master Report

**File Number: 20-1365**

**\*File ID #:** 20-1365

**Agenda Type:** Agenda Item

**Status:** Approved

**Version:** 1

**Reference:**

**Gov Body:** Board of Supervisors

**Created:** 10/07/2020

**Agenda Title:** 12/08/20 DOT FY19/20 TIM Fee Program Annual Report

**Final Action:** 12/08/2020

**Title:** Department of Transportation recommending the Board receive and file the Traffic Impact Mitigation Fee Program Annual Report for Fiscal Year 2019-20.

**FUNDING:** N/A

**Notes:**

**Sponsors:**

::

**Attachments:** A - Brief Description of Fees, B - Fee Schedules, C - Cash Statement

::

::

::

**Contact:** Rafael Martinez

::

**Related Files:**

### History of Legislative File

Version:	Acting Body:	Date:	Action:	Sent To:	Due Date:	Return Date:	Result:	
1	Board of Supervisors	12/08/2020	Approved				Pass	
<b>Action Text:</b> A motion was made by Supervisor Frentzen, seconded by Supervisor Parlin to Approve this matter.								
Mover:	Shiva Frentzen	Yes: 4 - Supervisor Frentzen, Supervisor Novasel, Supervisor Hidahl and Supervisor Parlin						4

### Text of Legislative File 20-1365

Department of Transportation recommending the Board receive and file the Traffic Impact Mitigation Fee Program Annual Report for Fiscal Year 2019-20.

**FUNDING:** N/A

## **DISCUSSION / BACKGROUND**

Pursuant to Section 66006 of the California Government Code, Mitigation Fee Act, the County is required to make available annually to the public specific information related to the prior Fiscal Year's activity for the County's Impact Fee Programs.

In compliance with Government Code Section 66006, Attachments A through C provide the following, related to the County's TIM Fee Programs for Fiscal Year (FY) 2019-20:

Attachment A - Brief Description of Types of TIM Fee Programs

Attachment B - Fee Schedules

Attachment C - Cash Statement

- Beginning and ending (cash) balance of the account
- Total fees collected
- Total interest earned in the fund
- Identification of each public improvement for which fees were expended
- Approximate date by which construction will commence
- A summary of loans or interfund transfer activity during the Fiscal Year
- Total refunds

## **ALTERNATIVES**

N/A

## **OTHER DEPARTMENT / AGENCY INVOLVEMENT**

Chief Administrative Office, Community Development Finance and Administration

## **CAO RECOMMENDATION**

It is recommended that the Board approve this item.

## **FINANCIAL IMPACT**

This item has no associated fiscal impact or change to Net County Cost.

## **CLERK OF THE BOARD FOLLOW UP ACTIONS**

Clerk of the Board to receive and file the Annual Report following Board approval.

## **COMMUNITY DEVELOPMENT SERVICES FOLLOW UP ACTIONS**

Chief Administrative Office, Community Development, Finance and Administration, will facilitate the posting of Attachments A through C of the Annual Report for FY 2019/20 to the El Dorado County, Department of Transportation website.

## **STRATEGIC PLAN COMPONENT**

Infrastructure

## **CONTACT**

Rafael Martinez, Director  
Department of Transportation

Becky Morton, Chief Fiscal Officer  
Chief Administrative Office, Community Development Finance and Administration

**ATTACHMENT A**

**El Dorado County**  
**Brief Description of the Types of Traffic Impact Mitigation Fees**  
**As required by Government Code Section 66006 (b) (1) (A)**

The purpose of the traffic impact mitigation (TIM) fees is to finance capital transportation/circulation improvements which are related directly to the incremental traffic/vehicle burden imposed upon the County's transportation/circulation system by new development in the unincorporated west slope of El Dorado County through 2040. Improvements funded by the TIM Fee Program include, but are not limited to, new roadways, roadway widenings, roadway intersection improvements, operational and safety improvement, bridge replacement and rehabilitation, and transit. Fees are derived by establishing that there is a reasonable relationship between the need for the described public facilities and the impacts of the types of development being charged.

**General Plan Traffic Impact Mitigation (TIM) Fee Program**

The General Plan Traffic Impact Mitigation Fee Program addresses the need to fund a road system capable of achieving the traffic level of service standards of the General Plan. This fee program succeeds the 2004 General Plan Traffic Impact Mitigation Fee Program as well as all subsequent fee programs.

A major revision of the TIM Fee Program was adopted on December 6, 2016 and went into effect on February 13, 2017 (Resolution #191-2016). As a result of this Resolution, the following four TIM Fee Funds are as follows:

1. TIM – Zone 8 El Dorado Hills (Acct 3670715)
2. TIM – Silva Valley Interchange Zone 8 (Acct 3670716)
3. TIM – Zones 1-7 (Acct 3670717)
4. TIM HWY 50 (Acct 3670718)

An update of the TIM Fee Program was adopted on May 14, 2019 and went into effect on July 15, 2019 (Resolution No. 072-2019). The zones that comprise the TIM Fee program are:

- ✓ Fee Zone 1 – Grizzly Flat/Quintette/West of Echo Summit
- ✓ Fee Zone 2 – Cameron Park/Shingle Springs
- ✓ Fee Zone 3 – El Dorado/Diamond Springs
- ✓ Fee Zone 4 – Coloma/Cool/Georgetown
- ✓ Fee Zone 5 – Placerville/Camino/Pollock Pines
- ✓ Fee Zone 6 – Pleasant Valley
- ✓ Fee Zone 7 – Fairplay/Latrobe/Mt. Aukum
- ✓ Fee Zone 8 – El Dorado Hills

In all the zones, there is a specified local component to the fee and a specified Hwy 50 component. The local component of fees collected from Zones 1-7 are pooled for use on future projects in any of these zones, but the amount used in each zone should ultimately approximate the amount of fees collected from that zone. Revenues collected are deposited into TIM – Zones 1-7 (Acct 3670717)

Local funds collected from Zone 8 are held separately due to pre-existing agreements and due to development in this area under the previously created El Dorado Hills/Salmon Falls Area Road Improvement Fee (RIF) program. Revenues collected are deposited into TIM – Zone 8 El Dorado Hills (Acct 3670715) 70% and into TIM – Silva Valley Interchange Zone 8 (Acct 3670716) 30%.

Highway 50 fees collected from all the zones are pooled and used on projects along Highway 50. Revenues collected are deposited into TIM HWY 50 (Acct 3670718).

Fees were established by estimating projected costs of future projects and spreading those costs among the eight zones based on traffic volumes from each zone. Costs were divided by future growth projections to determine fees.

Project costs are paid by the account in which the project is located. A fair share allocation is also made annually in order to transfer this year's percentage of -2.36% of TIM Fee revenues received in TIM Zones 1-7 account to TIM Zone 8 and the TIM Silva Valley Interchange accounts representing the zones fair share of the program costs. This allocation facilitates the need for each zone to pay its fair share of all project costs in the program. The entry for Fiscal Year 2019/2020 was a debit of \$46,917.97 for TIM Zone 8 and correspondingly a credit to TIM Silva Valley Interchange for \$34,096.21 and a credit to TIM Zones 1-7 of \$12,821.76.

More information about the various programs can be found in El Dorado County Ordinance Nos. 5044 and 5045, and the enabling Board Resolutions Nos. 021-2012, 191-2016, 001-2017, 189-2016, and 190-2016.

### **BAR J Trust Road Impact Fee**

Established by Resolution 304-99 on December 14, 1999, the Country Club Drive-Tierra De Dios Area of Benefit (see map, figure 2) is intended to reimburse Bell Ranch Properties, LTD, the Developer that constructed improvements and realigned Country Club Drive and Tierra De Dios in the Cameron Park area. The associated fee is based on the apportionment of costs to benefiting properties as defined in the Engineer's Report for the Area of Benefit. These funds are collected by the County and are deposited into the Bar J Trust account, then disbursed to Bell Ranch Properties, LTD as reimbursement for the constructed improvements. Refer to Attachment B for details of fee calculation.

### **Marble Valley Road – Road Impact Fee**

Established by Resolution 118-2000 on May 2, 2000, the Marble Valley Road Area of Benefit (see map, figure 3) and its associated impact fee, are intended to be used to reimburse Developer(s) that build the future roadway known as Marble Valley Road. The fee, which is collected with the building permit application, is based on the percentage of peak hour trips allocated to the property as detailed in the Traffic Analysis for Marble Valley Road, an appendix of the Engineer's Report for the Area of Benefit. Refer to Attachment B for details of fee calculation.

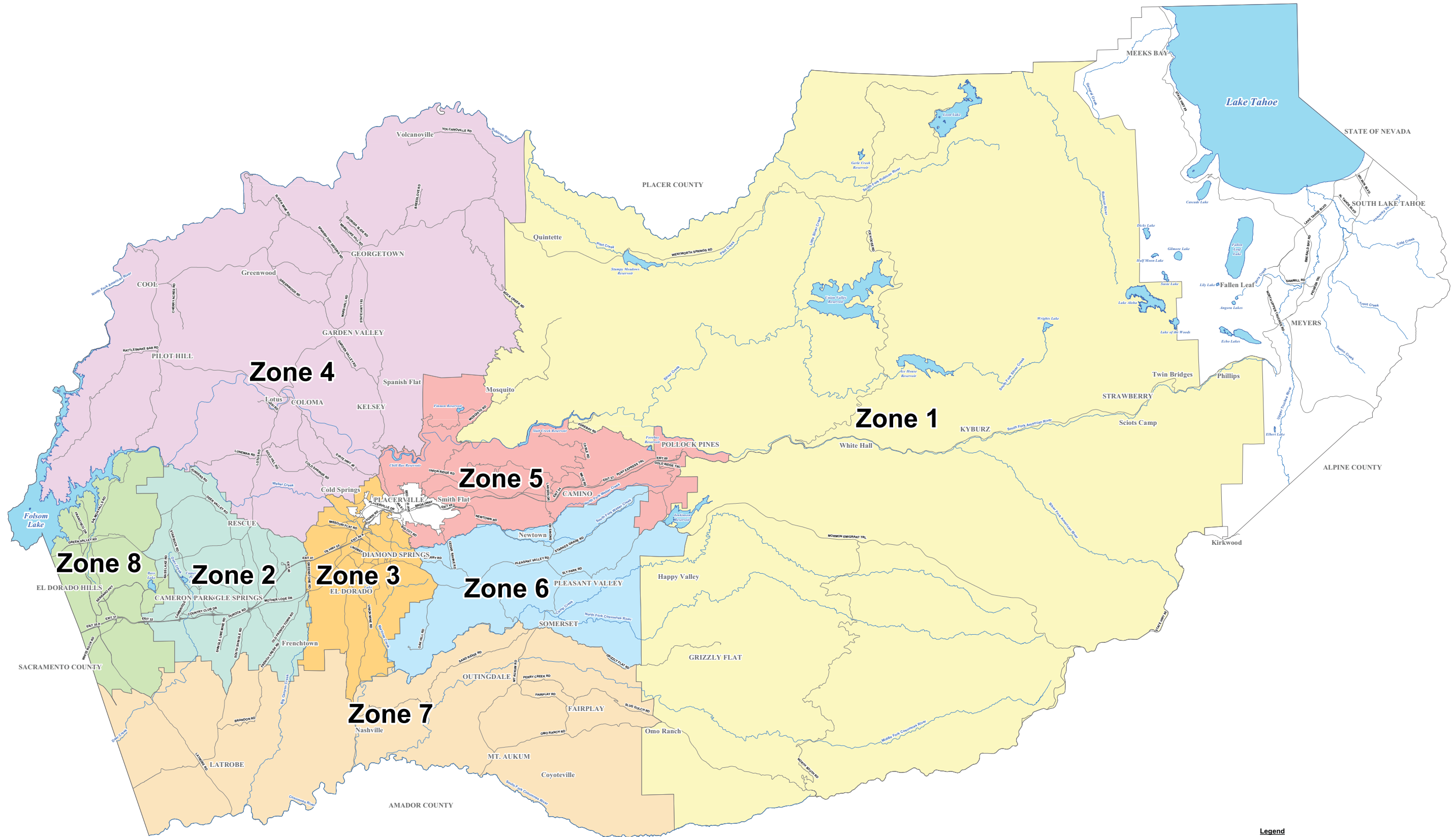

**Legend**

**TIM Fee Zones**

- 1 Grizzly Flat/Quintette/west of Echo Summit
- 2 Cameron Park/Shingle Springs
- 3 El Dorado/Diamond Springs
- 4 Coloma/Cool /Georgetown
- 5 Placerville/Camino/Pollock Pines
- 6 Pleasant Valley
- 7 Fairplay/Latrobe/Mt Aukum
- 8 El Dorado Hills

~ Major Roads

~ Rivers & Creeks

**20-1365 A 4 of 6**

0 1 2 4 6 Miles

Map displayed in State Plane Coordinate System (NAD 1983 California Zone 2, feet)

**Exhibit B**  
**TIM Fee Zone Map**  
**County of El Dorado**  
**State of California**



**DISCLAIMER:**  
 THIS DEPICTION WAS COMPILED FROM UNVERIFIED PUBLIC AND PRIVATE SOURCES AND IS ILLUSTRATIVE ONLY. NO REPRESENTATION IS MADE AS TO ACCURACY OF THIS INFORMATION. PARCEL BOUNDARIES ARE PARTICULARLY UNRELIABLE. USERS MAKE USE OF THIS DEPICTION AT THEIR OWN RISK.

**NOTES:**  
 LAYER INFORMATION MAY COVER ADDITIONAL AREAS OUTSIDE OF THE DISPLAYED AREA.

PREPARED AT THE REQUEST OF: CDA/LRP, DATE: 10/10/2016  
 MAP PREPARED BY: K. JACKSON, DATE: 10/10/2016  
 G.I.S. PROJECT ID: n/a, RELATED REPORT: n/a  
 EL DORADO COUNTY SURVEYOR/REG. I.S. DIVISION  
 PHONE: (530) 621-6511 FAX: (530) 628-4731

FIGURE 2

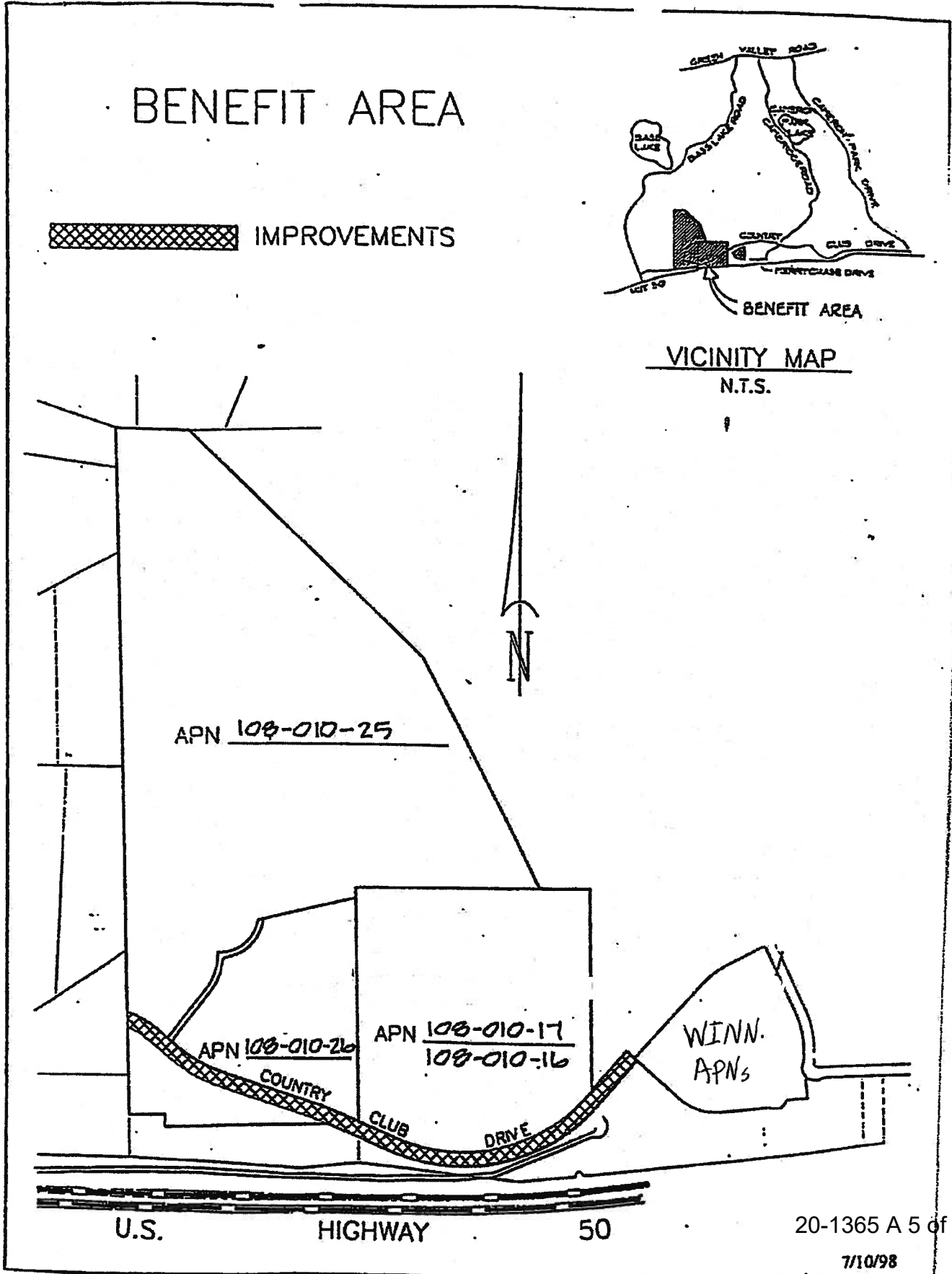



022262

FIGURE 3

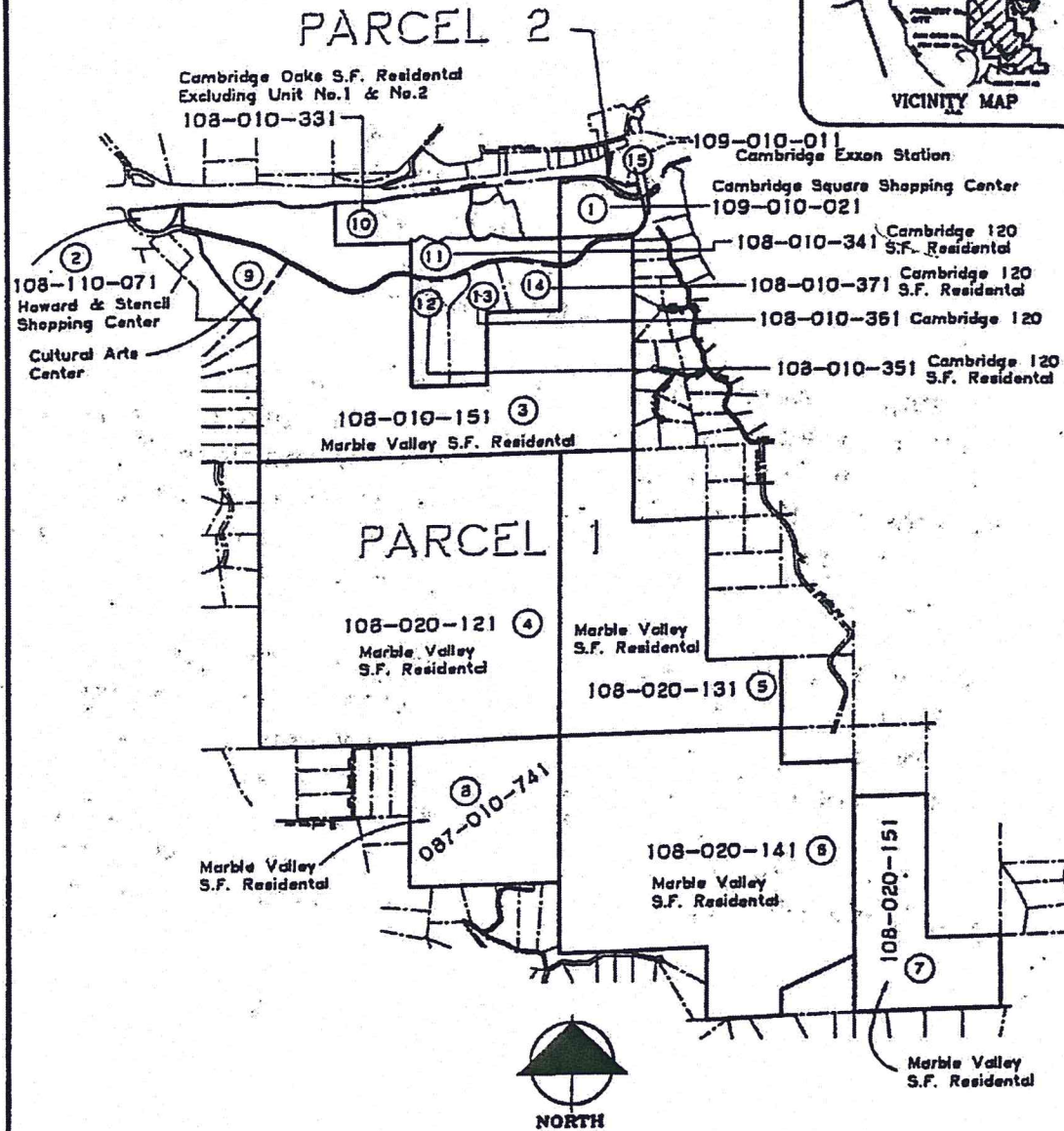
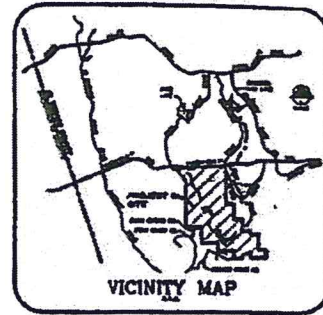

EXHIBIT D-1

MARBLE VALLEY ROAD  
AREA OF BENEFIT

**MARBLE VALLEY**

El Dorado Hills, California  
AREA OF BENEFIT MAP - DECEMBER 1998  
Revised March 2000

20-1365 A 6 of 6

**ATTACHMENT B**

**Traffic Impact Fees - Local and Highway 50**  
**Zones 1-8**  
**Effective July 1, 2019 through July 14, 2019**

Zone	Resolution Date	Effective Date	Resolution #	Description	Single Family per DU	Multi-Family per DU	Senior Adult Single Family per DU	Senior Adult Multi-Family per DU	General Commercial per Sq.Ft.	Hotel / Motel / Bed & Breakfast per room	Church per Sq.Ft.	Office / Medical per Sq.Ft.	Industrial / Warehouse per Sq.Ft.
ZONE 1	6/26/2018	8/27/2018	077-2018	2004 General Plan Traffic Impact Fees - Local	\$ 1,978	\$ 1,226	N/A	N/A	\$ 0.58	\$ 92	\$ 0.11	\$ 0.38	\$ 0.26
	6/26/2018	8/27/2018	077-2018	2004 General Plan Traffic Impact Fees - Highway 50	\$ 2,461	\$ 1,526	N/A	N/A	\$ 0.73	\$ 114	\$ 0.14	\$ 0.47	\$ 0.33
ZONE 2	6/26/2018	8/27/2018	077-2018	2004 General Plan Traffic Impact Fees - Local	\$ 8,615	\$ 5,341	\$ 2,326	\$ 2,154	\$ 2.55	\$ 400	\$ 0.50	\$ 1.65	\$ 1.15
	6/26/2018	8/27/2018	077-2018	2004 General Plan Traffic Impact Fees - Highway 50	\$ 11,291	\$ 7,000	\$ 3,049	\$ 2,823	\$ 3.34	\$ 524	\$ 0.65	\$ 2.16	\$ 1.51
ZONE 3	6/26/2018	8/27/2018	077-2018	2004 General Plan Traffic Impact Fees - Local	\$ 8,615	\$ 5,341	\$ 2,326	\$ 2,154	\$ 2.55	\$ 400	\$ 0.50	\$ 1.65	\$ 1.15
	6/26/2018	8/27/2018	077-2018	2004 General Plan Traffic Impact Fees - Highway 50	\$ 11,291	\$ 7,000	\$ 3,049	\$ 2,823	\$ 3.34	\$ 524	\$ 0.65	\$ 2.16	\$ 1.51
ZONE 4	6/26/2018	8/27/2018	077-2018	2004 General Plan Traffic Impact Fees - Local	\$ 1,656	\$ 1,027	N/A	N/A	\$ 0.49	\$ 77	\$ 0.10	\$ 0.32	\$ 0.22
	6/26/2018	8/27/2018	077-2018	2004 General Plan Traffic Impact Fees - Highway 50	\$ 2,900	\$ 1,798	N/A	N/A	\$ 0.86	\$ 135	\$ 0.17	\$ 0.56	\$ 0.39
ZONE 5	6/26/2018	8/27/2018	077-2018	2004 General Plan Traffic Impact Fees - Local	\$ 1,656	\$ 1,027	N/A	N/A	\$ 0.49	\$ 77	\$ 0.10	\$ 0.32	\$ 0.22
	6/26/2018	8/27/2018	077-2018	2004 General Plan Traffic Impact Fees - Highway 50	\$ 2,888	\$ 1,791	N/A	N/A	\$ 0.85	\$ 134	\$ 0.17	\$ 0.55	\$ 0.39
ZONE 6	6/26/2018	8/27/2018	077-2018	2004 General Plan Traffic Impact Fees - Local	\$ 4,559	\$ 2,827	N/A	N/A	\$ 1.35	\$ 212	\$ 0.26	\$ 0.87	\$ 0.61
	6/26/2018	8/27/2018	077-2018	2004 General Plan Traffic Impact Fees - Highway 50	\$ 2,585	\$ 1,603	N/A	N/A	\$ 0.76	\$ 120	\$ 0.15	\$ 0.49	\$ 0.34
ZONE 7	6/26/2018	8/27/2018	077-2018	2004 General Plan Traffic Impact Fees - Local	\$ 5,758	\$ 3,570	N/A	N/A	\$ 1.70	\$ 267	\$ 0.33	\$ 1.10	\$ 0.77
	6/26/2018	8/27/2018	077-2018	2004 General Plan Traffic Impact Fees - Highway 50	\$ 5,487	\$ 3,402	N/A	N/A	\$ 1.62	\$ 255	\$ 0.32	\$ 1.05	\$ 0.73
ZONE 8	6/26/2018	8/27/2018	077-2018	2004 General Plan Traffic Impact Fees - Local	\$ 20,575	\$ 12,757	\$ 5,555	\$ 5,144	\$ 6.09	\$ 955	\$ 1.19	\$ 3.94	\$ 2.74
	6/26/2018	8/27/2018	077-2018	2004 General Plan Traffic Impact Fees - Highway 50	\$ 8,809	\$ 5,462	\$ 2,378	\$ 2,202	\$ 2.61	\$ 409	\$ 0.51	\$ 1.69	\$ 1.18

**Traffic Impact Fees - Local and Highway 50**  
**Zones 1-8**  
**Effective July 15, 2019 through June 30, 2020**

Zone	Resolution Date	Effective Date	Resolution #	Description	Single Family per DU	Multi-Family per DU	Senior Adult Single Family per DU	Senior Adult Multi-Family per DU	General Commercial per Sq.Ft.	Hotel / Motel / Bed & Breakfast per room	Church per Sq.Ft.	Office / Medical per Sq.Ft.	Industrial / Warehouse per Sq.Ft.
ZONE 1	5/14/2019	7/15/2019	072-2019	2004 General Plan Traffic Impact Fees - Local	\$ 2,099	\$ 1,301	N/A	N/A	\$ 0.62	\$ 97	\$ 0.12	\$ 0.40	\$ 0.28
	5/14/2019	7/15/2019	072-2019	2004 General Plan Traffic Impact Fees - Highway 50	\$ 2,552	\$ 1,582	N/A	N/A	\$ 0.75	\$ 118	\$ 0.15	\$ 0.49	\$ 0.34
ZONE 2	5/14/2019	7/15/2019	072-2019	2004 General Plan Traffic Impact Fees - Local	\$ 9,048	\$ 5,610	\$ 2,443	\$ 2,262	\$ 2.68	\$ 420	\$ 0.52	\$ 1.73	\$ 1.21
	5/14/2019	7/15/2019	072-2019	2004 General Plan Traffic Impact Fees - Highway 50	\$ 11,721	\$ 7,267	\$ 3,165	\$ 2,930	\$ 3.47	\$ 544	\$ 0.68	\$ 2.24	\$ 1.56
ZONE 3	5/14/2019	7/15/2019	072-2019	2004 General Plan Traffic Impact Fees - Local	\$ 9,048	\$ 5,610	\$ 2,443	\$ 2,262	\$ 2.68	\$ 420	\$ 0.52	\$ 1.73	\$ 1.21
	5/14/2019	7/15/2019	072-2019	2004 General Plan Traffic Impact Fees - Highway 50	\$ 11,721	\$ 7,267	\$ 3,165	\$ 2,930	\$ 3.47	\$ 544	\$ 0.68	\$ 2.24	\$ 1.56
ZONE 4	5/14/2019	7/15/2019	072-2019	2004 General Plan Traffic Impact Fees - Local	\$ 1,728	\$ 1,071	N/A	N/A	\$ 0.51	\$ 80	\$ 0.10	\$ 0.33	\$ 0.23
	5/14/2019	7/15/2019	072-2019	2004 General Plan Traffic Impact Fees - Highway 50	\$ 3,009	\$ 1,866	N/A	N/A	\$ 0.89	\$ 140	\$ 0.17	\$ 0.58	\$ 0.40
ZONE 5	5/14/2019	7/15/2019	072-2019	2004 General Plan Traffic Impact Fees - Local	\$ 1,714	\$ 1,063	N/A	N/A	\$ 0.51	\$ 80	\$ 0.10	\$ 0.33	\$ 0.23
	5/14/2019	7/15/2019	072-2019	2004 General Plan Traffic Impact Fees - Highway 50	\$ 2,997	\$ 1,858	N/A	N/A	\$ 0.89	\$ 139	\$ 0.17	\$ 0.57	\$ 0.40
ZONE 6	5/14/2019	7/15/2019	072-2019	2004 General Plan Traffic Impact Fees - Local	\$ 4,851	\$ 3,008	N/A	N/A	\$ 1.44	\$ 225	\$ 0.28	\$ 0.93	\$ 0.65
	5/14/2019	7/15/2019	072-2019	2004 General Plan Traffic Impact Fees - Highway 50	\$ 2,682	\$ 1,663	N/A	N/A	\$ 0.79	\$ 124	\$ 0.16	\$ 0.51	\$ 0.36
ZONE 7	5/14/2019	7/15/2019	072-2019	2004 General Plan Traffic Impact Fees - Local	\$ 6,052	\$ 3,752	N/A	N/A	\$ 1.79	\$ 281	\$ 0.35	\$ 1.16	\$ 0.81
	5/14/2019	7/15/2019	072-2019	2004 General Plan Traffic Impact Fees - Highway 50	\$ 5,695	\$ 3,531	N/A	N/A	\$ 1.68	\$ 264	\$ 0.33	\$ 1.09	\$ 0.76
ZONE 8	5/14/2019	7/15/2019	072-2019	2004 General Plan Traffic Impact Fees - Local	\$ 20,130	\$ 12,481	\$ 5,435	\$ 5,033	\$ 5.95	\$ 934	\$ 1.17	\$ 3.85	\$ 2.69
	5/14/2019	7/15/2019	072-2019	2004 General Plan Traffic Impact Fees - Highway 50	\$ 9,163	\$ 5,681	\$ 2,474	\$ 2,291	\$ 2.71	\$ 425	\$ 0.53	\$ 1.75	\$ 1.22

**County of El Dorado - Country Club Drive / Tierra De Dios Area of Benefit  
Benefit Roll & Spread (Fees collected based on these assessed amounts)  
Effective July 1, 2014 through June 30, 2020**

Benefit Number	Development Project	Assessors Parcel Number	Percent of Benefit	Assessed Amount
1	Bell Ranch (No payment due - Constructed improvements)	108-010-25	38.3%	\$ 232,445
2	Roman Catholic Property	108-010-16 & 17	24.7%	\$ 149,429
3	Holy Trinity Church & School Buildings	108-010-26	26.1%	\$ 158,353
4	Winncrest - Bar J (Paid in Full)	Various	10.9%	\$ 66,074

**County of El Dorado - Marble Valley Road Area of Benefit  
Benefit Roll & Spread (Fees collected based on these assessed amounts)  
Effective July 1, 2014 through June 30, 2020**

Benefit Number <small>(See Maps, Figure 6)</small>	Development Project and Land Use	Assessors Parcel Number	Percent Trips	Original Assessed Amount
1	Cambridge Square Shopping Center	109-010-021	31.0%	\$ 1,246,257
2	Howard & Stancil Single Family Residential	108-110-071	0.1%	\$ 4,020
3	Marble Valley Single Family Residential	108-010-151		
4	Marble Valley Single Family Residential	108-020-121		
5	Marble Valley Single Family Residential	108-020-131	49.8%	\$ 2,002,052
6	Marble Valley Single Family Residential	108-020-141		
7	Marble Valley Single Family Residential	108-020-151		
8	Marble Valley Single Family Residential	087-200-741		
9	Cultural Arts Center	Por 108-010-151	11.6%	\$ 466,341
10	Cambridge Oaks Single Family Residential (Excluding Units 1 & 2)	108-010-331	1.4%	\$ 56,283
11	Cambridge 120 Single Family Residential	108-010-341		
12	Cambridge 120 Single Family Residential	108-010-351	0.0%	\$ -
13	Cambridge 120 Single Family Residential	108-010-361		
14	Cambridge 120 Single Family Residential	108-010-371		
15	Cambridge Exxon Station	109-010-011	6.1%	\$ 245,231

**ATTACHMENT C**

El Dorado County, Community Development Services, Department of Transportation  
Public Notice of Impact Fee Accounts  
Fiscal Year 19/20

Fee Schedule is located on CDS Website at  
<https://www.edcgov.us/Government/dot/Pages/timreporting.aspx>

	TIM - Zone 8 El Dorado Hills Acct. 3670715	TIM - Silva Valley Interchange Acct. 3670716	TIM Zones 1-7 Acct. 3670717	TIM Highway 50 Acct. 3670718		
<b>Beginning Cash Balance 7/1/19</b>	<b>14,544,887</b>	<b>3,388,859</b>	<b>10,223,484</b>	<b>19,337,923</b>		
<b>Residual Equity Transfers In</b>	-	-	-	-		
<b>Fees Collected FY 19/20</b>	4,618,598	2,209,585	551,627	3,655,233		
<b>Accruals FY 19/20</b>	-	-	-	-		
<b>Accounts Receivable</b>	-	-	-	-		
<b>Reverse Prior Year Accruals</b>	-	(76,888)				
<b>Reverse Prior Year Receivable</b>	-	-	4,559	2,585		
<b>Refunds</b>	(466,391)	(4,771)	(7,381)	(16,640)		
<b>Developer Cash Advance/Repayment</b>	(1,476,861)	(2,670,943)	-	-		
<b>Interest Earned</b>	315,993	89,142	200,949	397,335		
<b>Loans or Inter-Fund Transfers</b>	-	-	-	-		
<b>Fair Share Allocations</b>	(46,918)	34,096	12,822	-		
<b>NET REVENUE</b>	<b>2,944,422</b>	<b>(419,778)</b>	<b>762,576</b>	<b>4,038,513</b>		
<b>Public Improvement Expenditures</b>	<b>Project #</b>	<b>Fenix #</b>			<b>Approximate Construction Start Date</b>	<b>(1) Life to Date % Funded with Impact Fees</b>
GENERAL PLAN TRANSPORTATION IMPACT FEES UPDATE	34007	36201014	82,018	94,630	N/A	100%
UPDATE TRAFFIC MODEL	34014	36201016	237	273	N/A	100%
CAPITAL IMPROVEMENT PROGRAM (CIP) - UPDATE MAJOR	34032	36201013	31,822	36,716	N/A	59%
GP TRANSPORTATION IMPACT FEES MINOR UPDATE	34047	36201014			N/A	100%
LATROBE ROAD CONNECTOR TO WHITE ROCK RD - STUDY	66116	36105024	27,640		Beyond 2024	94%
SARATOGA WAY EXTENSION PH 1	71324	36105034	339,433		FY 2019/2020	100%
SILVA VALLEY/US 50 INTERCHANGE	71328	36104002		54,365	Complete	44%
U.S. 50/PONDEROSA RD/SO. SHINGLE RD INTERCHANGE IMPROVEMENTS	71333	36104010			46,118	Beyond 2030 97%
U.S 50/PONDEROSA ROAD INTERCHANGE - DUROCK RD REALIGNMENT	71338	36104008				Beyond 2030 94%
SILVA VALLEY US 50 INTERCHANGE PHASE 1A	71368	36104003		31,897		FY 2019/2020 100%
CAMERON PARK DR - PALMER DR TO HACIENDA WIDENING	72143	36105004		38,999		FY 2020/2021 100%
DIAMOND SPRINGS PARKWAY	72334	36105011				FY 2021/2022 63%
U.S. 50 CAMERON PARK DRIVE INTERCHANGE	72361	36104007			870	Beyond 2030 100%
GREEN VALLEY RD WIDENING - COUNTY LINE TO SOPHIA PARKWAY	72376	36105013	8,040		NA	28%
WHITE ROCK WIDENING (2-4 LANES) MANCHESTER DRIVE TO SAC COUNTY LINE	72381	36105041	27,983			Beyond 2030 28%
SR 49/PATTERSON DR SIGNAL	73320	36104027		74,958		Project Closed 23%
ENTERPRISE DR/MISSOURI FLAD RD SIGNALIZATION	73365	36105052		15,355		FY 2021/2022 60%
US50/EB BASS LAKE SIGNAL	73367	36104030			90,639	FY 2021/2022 96%
SILVER SPRINGS PKWY EXTENSION	76108	36105039		589,893		FY 2021/2022 82%
GREEN VALLEY@WEBER CRK-BRIDGE	77114	36105017		(354,031)		FY 2019/2020 2%
SLY PARK ROAD CLEAR CREEK CROSSING BRIDGE REHAB	77115	36105040		326,253		FY 2018/2019 9%
BUCKS BAR N FORK COSUMNES RIVER BRIDGE	77116	36105003		13,060		FY 2020/2021 6%
GREEN VALLEY ROAD AT INDIAN CREEK - BRIDGE REPLACEMENT	77127	36105014		959		FY 2021/2022 7%
GREEN VALLEY ROAD AT MOUND SPRINGS CREEK - BRIDGE REPLACEMENT	77136	36105015		248		FY 2021/2022 8%
<b>Total Public Improvement Expenditures (Cash)</b>	<b>517,172</b>	<b>86,262</b>	<b>837,314</b>	<b>137,628</b>		
<b>Ending Cash Balance 6/30/20</b>	<b>16,972,137</b>	<b>2,882,819</b>	<b>10,148,746</b>	<b>23,238,807</b>		



El Dorado County, Community Development Services, Department of Transportation  
 Public Notice of Impact Fee Accounts  
 Fiscal Year 19/20

<b>Fee Schedule is located on CDA Website at <a href="https://www.edcgov.us/Government/dot/Pages/timreporting.aspx">https://www.edcgov.us/Government/dot/Pages/timreporting.aspx</a></b>	BAR J Trust Road Impact Fee Acct. 7936465 79360465	Marble Valley Road Road Impact Fee Acct. 7936466 79360466	
<b>Beginning Cash Balance 07/01/19</b>	<b>195</b>	<b>56,693</b>	
<b>Fees Collected FY 19/20</b>		-	
<b>Refunds</b>			
<b>Interest Earned</b>	4	1,069	
<b>Loans or Inter-Fund Transfers</b>			
<b><u>Public Improvement Expenditures</u></b>	<b><u>Project #</u></b>		<b><u>Approximate Construction Start Date</u></b>
N/A	N/A		N/A
			<b><u>(1) Life to Date % Funded with Impact Fees</u></b>
			N/A
Reverse Accruals	-	-	
Total Public Improvement Expenditures (Cash)	-	-	
<b>Ending Cash Balance 06/30/20</b>	<b>199</b>	<b>57,762</b>	

(1) Does not reflect final project funding percentage